

管材Pipe(Schedule80)/(Schedule40)/(D1785)

Nominal Size	D	Tolerance	Socket Type			
			SCH80		SCH40	
			T(min/mm)	Tolerance	T(min/mm)	Tolerance
1/2"	21.34	±0.10	3.73	+0.51	2.77	+0.51
3/4"	26.67	±0.10	3.91	+0.51	2.87	+0.51
1"	33.40	±0.13	4.55	+0.53	3.38	+0.51
1-1/4"	42.16	±0.13	4.85	+0.58	3.56	+0.51
1-1/2"	48.26	±0.15	5.08	+0.61	3.68	+0.51
2"	60.32	±0.15	5.54	+0.66	3.91	+0.51
2-1/2"	73.02	±0.18	7.01	+0.84	5.16	+0.61
3"	88.90	±0.20	7.62	+0.91	5.49	+0.66
4"	114.30	±0.23	8.56	+1.02	6.02	+0.71
5"	141.30	±0.25	9.52	+1.14	6.55	+0.79
6"	168.28	±0.28	10.97	+1.32	7.11	+0.86
8"	219.08	±0.38	12.70	+1.52	8.18	+0.99
10"	273.50	±0.38	15.06	+1.80	9.27	+1.12
12"	323.85	±0.38	17.45	+2.08	10.31	+1.24
14"	355.60	±0.38	19.05	+2.28	11.10	+1.35

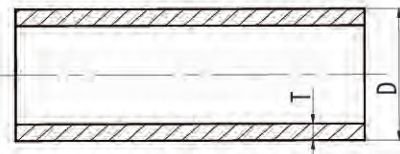

管Pipe(DIN)(GB-T10002.1-2006)

Nominal Size	D	Tolerance	Socket Type			
			PN1.0		PN1.6	
			厚度	Tolerance	厚度	Tolerance
1/2"	20	+0.3	2.0	+0.2	2.0	+0.2
3/4"	25	+0.3	2.0	+0.2	2.0	+0.2
1"	32	+0.3	2.0	+0.2	2.4	+0.2
1-1/4"	40	+0.3	2.0	+0.2	3.0	+0.2
1-1/2"	50	+0.3	2.4	+0.2	3.7	+0.2
2"	63	+0.3	3.0	+0.2	4.7	+0.2
2-1/2"	75	+0.3	3.6	+0.3	5.6	+0.3
3"	90	+0.3	4.3	+0.3	6.7	+0.3
4"	110	+0.4	4.2	+0.4	6.6	+0.4
5"	140	+0.5	5.4	+0.4	8.3	+0.4
6"	160	+0.5	6.2	+0.4	9.5	+0.4
8"	200	+0.6	7.7	+0.4	11.9	+0.4
8"	225	+0.7	8.6	+0.4	13.4	+0.4
10"	250	+0.8	9.6	+0.4	14.8	+0.4
10"	280	+0.9	10.7	+0.4	16.6	+0.4
12"	315	+1.0	12.1	+0.5	18.7	+0.5

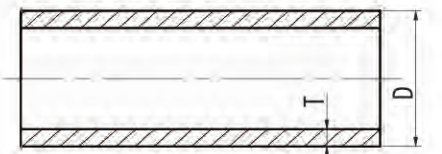

管Pipe(DIN)(GB-T4219-2008)

Nominal Size	D	Tolerance	Socket Type		
			T(min)	Tolerance	Pressure
DN15	20	+0.2	2.3	+0.5	-
DN20	25	+0.2	2.8	+0.5	-
DN25	32	+0.2	3.6	+0.5	-
DN32	40	+0.2	3	+0.6	S6.3
DN40	50	+0.2	3.7	+0.7	S6.3
DN50	63	+0.3	4.7	+0.7	S6.3
DN65	75	+0.3	5.6	+0.8	S6.3
DN80	90	+0.3	6.7	+0.9	S6.3
DN100	110	+0.4	8.1	+1.1	S6.3
DN125	140	+0.5	10.3	+1.3	S6.3
DN150	160	+0.5	11.8	+1.4	S6.3
DN180	200	+0.6	14.7	+1.7	S6.3
DN200	225	+0.7	16.6	+1.9	S6.3
DN250	250	+0.8	18.4	+2.3	S6.3
DN300	315	+1.0	23.2	+2.6	S6.3
DN350	355	+1.1	26.1	+2.9	S6.3

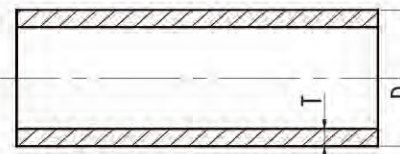

直接头Coupling(SxS)

ANSI		NSF				
Nominal	Outside Dia	Socket Type			Structural Diameter	
Size	D	d1	d2	l	d	L
1/2"	30.00	21.54	21.23	24.00	16.00	52.00
3/4"	35.00	26.87	26.57	27.00	22.00	58.00
1"	44.00	33.65	33.27	30.00	30.00	64.00
1-1/4"	54.00	42.42	42.04	34.00	38.00	72.00
1-1/2"	60.00	48.56	48.11	37.00	43.00	78.00
2"	73.00	60.63	60.17	41.00	54.00	86.00
2-1/2"	88.00	73.38	72.85	46.50	67.00	98.00
3"	105.00	89.31	88.70	50.00	82.00	107.00
4"	132.00	114.76	114.10	60.00	106.00	126.00
5"	162.00	141.81	141.00	77.00	133.00	162.00
6"	193.00	168.83	168.00	79.00	158.00	168.00
8"	261.00	219.84	218.70	103.00	214.00	215.00
10"	305.80	273.81	272.67	128.00	265.00	266.00
12" (手工件)	360.00	324.61	323.47	168.00	190.00	386.00

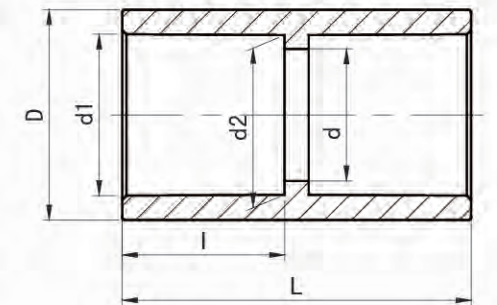

Note: Dimensions for handmade fittings shall per actual ones.
备注：手工件请以实物为准

内牙直接头Female Adapter(SxT)

ANSI



Nominal Size	Outside Dia D	Socket Type			Structural Diameter		
		d1	d2	l	d	L	NPT(牙数/寸)
1/2"	30.00	21.54	21.23	24.00	13.20	52.00	14.00
3/4"	35.00	26.87	26.57	27.00	19.00	58.00	14.00
1"	44.00	33.65	33.27	30.00	24.00	64.00	11.50
1-1/4"	54.00	42.42	42.04	34.00	32.00	72.00	11.50
1-1/2"	60.00	48.56	48.11	37.00	38.00	78.00	11.50
2"	73.00	60.63	60.17	41.00	50.00	86.00	11.50

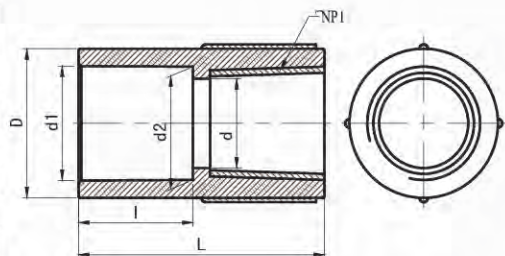

直接头Coupling(SxS)

DIN

Nominal Size	Socket Type			Structural Diameter		
	d1	d2	l	D	d	L
DN15	20.3	20.1	16.0	27.0	16.0	36.0
DN20	25.3	25.1	20.0	32.0	21.0	44.0
DN25	32.3	32.1	24.0	40.0	28.0	52.0
DN32	40.3	40.1	28.0	50.0	36.0	60.0
DN40	50.3	50.1	32.0	63.0	46.0	68.0
DN50	63.3	63.1	38.0	76.5	57.0	80.0
DN65	75.3	75.1	44.0	90.0	70.0	92.0
DN80	90.3	90.1	51.0	110.0	86.1	107.0
DN100	110.4	110.1	61.0	133.0	106.1	128.0
DN125	140.5	140.2	77.0	162.0	133.0	162.0
DN150	160.5	160.2	86.0	186.0	154.0	180.0
DN200	225.7	225.3	120.0	261.0	214.0	250.0
DN250 (手工件)	250.8	250.3	145.0	290.0	239.0	340.0
DN300 (手工件)	316.0	315.4	168.0	364.0	304.0	386.0

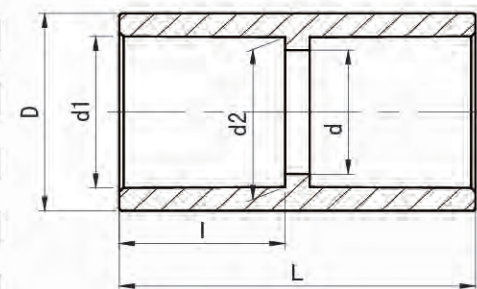

内牙直接头Female Adapter(TxT)

ANSI



Nominal Size	Outside Dia D	Structural Diameter		
		d	L	NPT(牙数/寸)
1/2"	30.00	16.0	52.00	14.00
3/4"	35.00	22.0	58.00	14.00
1"	44.00	30.0	64.00	11.50
1-1/4"	54.00	38.0	72.00	11.50
1-1/2"	60.00	43.0	78.00	11.50
2"	73.00	54.0	86.00	11.50

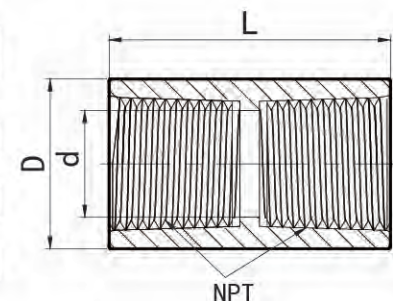

异径直接头Reducing Socket(SxS)

DIN

Nominal Size	Outside Dia		Socket Type						Structural Diameter	
	D1	D2	d1	d2	l1	d3	d4	l2	d	L
DN20*DN15	32.0	27.0	25.3	25.1	20.0	20.3	20.1	16.0	16.0	44.0
DN25*DN15	40.0	27.0	32.3	32.1	24.0	20.3	20.1	16.0	16.0	52.0
DN25*DN20	40.0	32.0	32.3	32.1	24.0	25.3	25.1	20.0	21.0	52.0
DN32*DN15	50.0	27.0	40.3	40.1	28.0	20.3	20.1	16.0	16.0	60.0
DN32*DN20	50.0	32.0	40.3	40.1	28.0	25.3	25.1	20.0	21.0	60.0
DN32*DN25	50.0	40.0	40.3	40.1	28.0	32.3	32.1	24.0	28.0	60.0
DN40*DN15	63.0	27.0	50.3	50.1	32.0	20.3	20.1	16.0	16.0	68.0
DN40*DN20	63.0	32.0	50.3	50.1	32.0	25.3	25.1	20.0	21.0	68.0
DN40*DN25	63.0	40.0	50.3	50.1	32.0	32.3	32.1	24.0	28.0	68.0
DN40*DN32	63.0	50.0	50.3	50.1	32.0	40.3	40.1	28.0	36.0	68.0
DN50*DN15	75.0	27.0	63.3	63.1	38.0	20.3	20.1	16.0	16.0	80.0
DN50*DN20	75.0	32.0	63.3	63.1	38.0	25.3	25.1	20.0	21.0	80.0
DN50*DN25	75.0	40.0	63.3	63.1	38.0	32.3	32.1	24.0	28.0	80.0
DN50*DN32	75.0	50.0	63.3	63.1	38.0	40.3	40.1	28.0	36.0	80.0
DN50*DN40	75.0	63.0	63.3	63.1	38.0	50.3	50.1	32.0	46.0	80.0

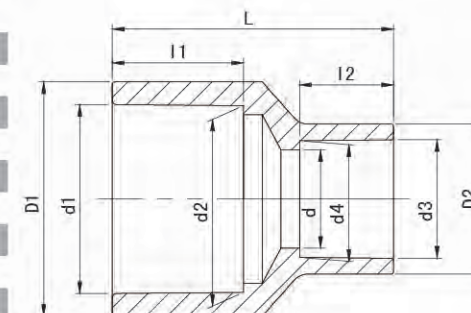

外牙接头Male Adapter(SxT)

ANSI



Nominal Size	Outside Dia D	Socket Type			Structural Diameter		
		d1	d2	l	d	L	NPT(牙数/寸)
1/2"	30.00	21.54	21.23	24.00	13.20	50.00	14.00
3/4"	35.00	26.87	26.57	27.00	19.00	50.50	14.00
1"	44.00	33.65	33.27	30.00	24.00	59.00	11.50
1-1/4"	54.00	42.42	42.04	34.00	32.00	63.40	11.50
1-1/2"	60.00	48.56	48.11	37.00	38.00	67.00	11.50
2"	73.00	60.63	60.17	41.10	50.00	73.00	11.50

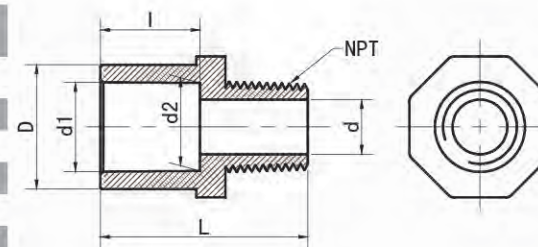

外牙接头Male Adapter(SxT)

DIN

Nominal Size	Outside Dia D	Socket Type			Structural Diameter		
		d1	d2	l	d	L	PT(牙数/寸)
DN15	30.0	20.3	20.1	16.0	13.2	50.0	14
DN20	35.0	25.3	25.1	19.0	19.0	50.5	14
DN25	44.0	32.3	32.1	22.0	24.0	59.0	11
DN32	54.0	40.3	40.1	26.0	32.0	63.4	11
DN40	60.0	50.3	50.1	32.0	38.0	67.0	11
DN50	73.0	63.3	63.1	38.0	50.0	73.0	11

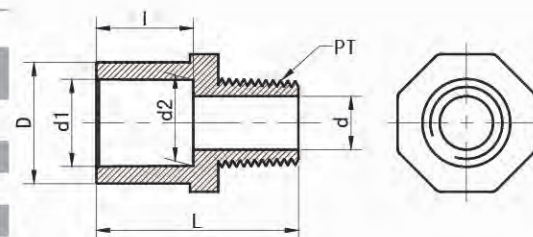

内牙接头Female Adaptor(SxT)

DIN

Nominal Size	Outside Dia D	Socket Type			Structural Diameter		
		d1	d2	l	d	L	PT(牙数/寸)
DN15	30.0	20.3	20.1	16.0	13.2	52.0	14
DN20	35.0	25.3	25.1	19.0	19.0	58.0	14
DN25	44.0	32.3	32.1	22.0	24.0	64.0	11
DN32	54.0	40.3	40.1	26.0	32.0	72.0	11
DN40	60.0	50.3	50.1	32.0	38.0	78.0	11
DN50	73.0	63.3	63.1	38.0	50.0	86.0	11

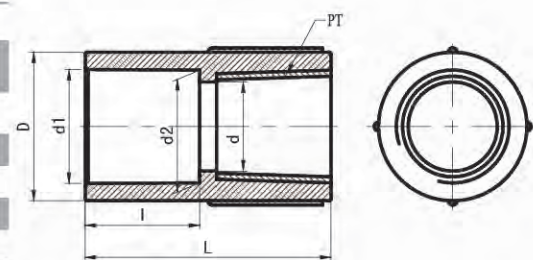

内牙接头Female Adaptor(TxT)

DIN

Nominal Size	Outside Dia D	Structural Diameter		
		d	L	PT(牙数/寸)
DN15	27	16	36	14
DN20	32	21	44	14
DN25	40	28	52	11
DN32	50	36	60	11
DN40	63	46	68	11
DN50	76.5	57	80	11

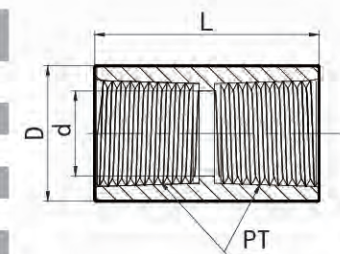

正三通Tee(SxSxS)

ANSI

Nominal Size	Outside Dia D	Socket Type			Structural Diameter		
		d1	d2	l	d	H	L
1/2"	29.00	21.54	21.23	24.00	16.00	51.50	74.00
3/4"	35.00	26.87	26.57	27.00	22.00	59.50	84.00
1"	44.00	33.65	33.27	30.00	30.00	70.00	96.00
1-1/4"	54.00	42.42	42.04	34.00	38.00	84.00	114.00
1-1/2"	60.00	48.56	48.11	37.00	44.00	93.00	126.00
2"	73.00	60.63	60.17	41.00	54.00	109.50	146.00
2-1/2"	88.00	73.38	72.85	46.50	67.00	129.50	171.00
3"	105.00	89.31	88.70	50.00	82.00	149.50	194.00
4"	132.00	114.76	114.10	60.00	106.00	185.00	238.00
5"	162.00	141.81	141.00	77.00	133.00	234.50	307.00
6"	191.00	168.83	168.00	79.00	158.00	263.50	336.00
8"	246.00	219.84	218.70	102.00	200.00	340.00	434.00
10"	300.80	273.81	272.67	128.00	265.00	423.40	546.00
12" (手工件)	360.00	324.61	323.47	168.00	190.00	553.00	686.00

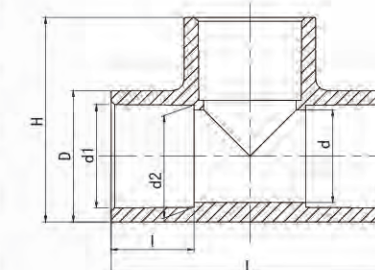

Note: Dimensions for handmade fittings shall per actual ones.
备注：手工件请以实物为准

正三通Tee(SxSxT)

ANSI

Nominal Size	Outside Dia D	Socket Type			Structural Diameter			
		d1	d2	l	d	H	L	NPT(牙数/寸)
1/2"	29.00	21.54	21.23	24.00	16.00	51.50	74.00	14.00
3/4"	35.00	26.87	26.57	27.00	22.00	59.50	84.00	14.00
1"	44.00	33.65	33.27	30.00	30.00	70.00	96.00	11.50
1-1/4"	54.00	42.42	42.04	34.00	38.00	84.00	114.00	11.50
1-1/2"	60.00	48.56	48.11	37.00	43.00	93.00	126.00	11.50
2"	73.00	60.63	60.17	41.00	54.00	109.50	146.00	11.50

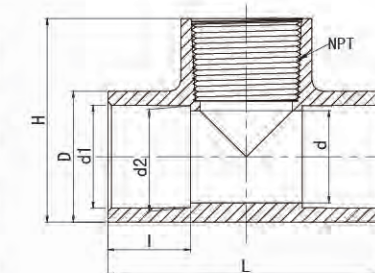

正三通 Tee(SxSxS)

Nominal	Socket Type			Structural Diameter			
	d1	d2	l	D	d	H	L
DN15	20.3	20.1	16.0	27.0	17.0	40.0	56.0
DN20	25.3	25.1	19.0	33.0	23.0	49.5	66.0
DN25	32.3	32.1	22.0	41.0	29.0	61.0	81.0
DN32	40.3	40.1	26.0	50.0	37.0	73.5	96.0
DN40	50.3	50.1	32.0	61.0	47.0	88.0	118.0
DN50	63.3	63.1	38.0	76.5	63.0	107.5	143.0
DN65	75.3	75.1	44.0	92.0	72.1	131.5	171.0
DN80	90.3	90.1	51.0	110.6	87.1	153.8	197.0
DN100	110.4	110.1	61.0	133.0	106.1	185.5	238.0
DN125	140.5	140.2	77.0	162.0	133.0	234.5	307.0
DN150	160.5	160.2	86.0	186.0	152.0	262.0	338.0
DN200	225.7	225.3	120.0	261.0	205.0	365.5	468.0
DN250 (手工件)	250.8	250.3	148.0	290.0	239.0	523.0	696.0
DN300 (手工件)	316.0	315.4	168.0	364.0	304.0	620.0	816.0

Note: Dimensions for handmade fittings shall per actual ones.
备注: 手工件请以实物为准

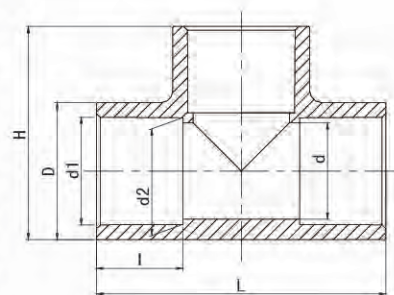

正三通 Tee(SxSxT)

Nominal	Outside Dia	Socket Type			Structural Diameter			
		d1	d2	l	d	H	L	PT(牙数/寸)
DN15	27.0	20.3	20.1	16.0	17.0	40.0	56.0	14.0
DN20	33.0	25.3	25.1	19.0	23.0	49.5	66.0	14.0
DN25	41.0	32.3	32.1	22.0	29.0	61.0	81.0	11.0
DN32	50.0	40.3	40.1	26.0	37.0	73.5	96.0	11.0
DN40	61.0	50.3	50.1	32.0	47.0	88.0	118.0	11.0
DN50	76.5	63.3	63.1	38.0	60.0	107.5	143.0	11.0

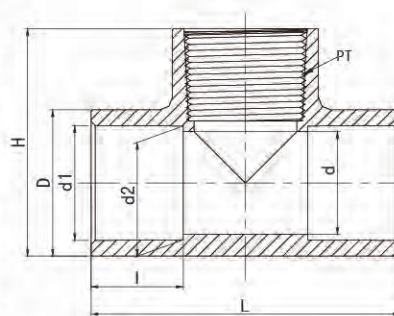

异径三通 Reducing Tee(SxSxS)

Nominal	Outside Dia	Socket Type						Structural Diameter					
		Size	D	d1	d2	l1	d3	d4	l2	d	d0	H	L
3/4*3/4*1/2"	35.00	26.87	26.57	27.00	21.54	21.23	24.00	22.00	16.00	57.00	78.00		
1*1*1/2"	44.00	33.65	33.27	30.00	21.54	21.23	24.00	30.00	16.00	65.00	90.00		
1*1*3/4"	44.00	33.65	33.27	30.00	26.87	26.57	27.00	30.00	22.00	68.00	90.00		
1-1/4*1-1/4*1/2"	54.00	42.42	42.04	34.00	21.54	21.23	24.00	38.00	16.00	74.00	106.00		
1-1/4*1-1/4*3/4"	54.00	42.42	42.04	34.00	26.87	26.57	27.00	38.00	22.00	77.00	106.00		
1-1/4*1-1/4*1"	54.00	42.42	42.04	34.00	33.65	33.27	30.00	38.00	30.00	80.00	106.00		
1-1/2*1-1/2*1/2"	60.00	48.56	48.11	37.00	21.54	21.23	24.00	43.00	16.00	79.50	120.00		
1-1/2*1-1/2*3/4"	60.00	48.56	48.11	37.00	26.87	26.57	27.00	43.00	22.00	82.50	120.00		
1-1/2*1-1/2*1"	60.00	48.56	48.11	37.00	33.65	33.27	30.00	43.00	30.00	85.50	120.00		
1-1/2*1-1/2*1-1/4"	60.00	48.56	48.11	37.00	42.42	42.04	34.00	43.00	38.00	90.50	120.00		
2*2*1/2"	73.00	60.63	60.17	41.00	21.54	21.23	24.00	54.00	16.00	91.50	135.00		
2*2*3/4"	73.00	60.63	60.17	41.00	26.87	26.57	27.00	54.00	22.00	94.50	135.00		
2*2*1"	73.00	60.63	60.17	41.00	33.65	33.27	30.00	54.00	30.00	97.50	135.00		
2*2*1-1/4"	73.00	60.63	60.17	41.00	42.42	42.04	34.00	54.00	38.00	101.50	135.00		
2*2*1-1/2"	73.00	60.63	60.17	41.00	48.56	48.11	37.00	54.00	43.00	105.50	135.00		
2-1/2*2-1/2*1/2"	88.00	73.38	72.85	46.50	21.54	21.23	24.00	67.00	16.00	105.50	159.00		
2-1/2*2-1/2*3/4"	88.00	73.38	72.85	46.50	26.87	26.57	27.00	67.00	22.00	108.50	159.00		
2-1/2*2-1/2*1"	88.00	73.38	72.85	46.50	33.65	33.27	30.00	67.00	30.00	111.50	159.00		
2-1/2*2-1/2*1-1/4"	88.00	73.38	72.85	46.50	42.42	42.04	34.00	67.00	38.00	115.50	159.00		
2-1/2*2-1/2*1-1/2"	88.00	73.38	72.85	46.50	48.56	48.11	37.00	67.00	43.00	118.50	159.00		
2-1/2*2-1/2*2"	88.00	73.38	72.85	46.50	60.63	60.17	41.00	67.00	54.00	123.50	159.00		
3*3*1"	105.50	89.31	88.70	50.00	33.65	33.27	30.00	82.00	30.00	127.75	179.00		
3*3*1-1/4"	105.50	89.31	88.70	50.00	42.42	42.04	34.00	82.00	38.00	131.75	179.00		
3*3*1-1/2"	105.50	89.31	88.70	50.00	48.56	48.11	37.00	82.00	43.00	134.75	179.00		
3*3*2"	105.50	89.31	88.70	50.00	60.63	60.17	41.00	82.00	54.00	138.75	179.00		
3*3*2-1/2"	105.50	89.31	88.70	50.00	73.38	72.85	46.50	82.00	67.00	145.25	179.00		
4*4*1"	133.00	114.76	114.10	60.00	33.65	33.27	30.00	106.00	30.00	153.50	214.00		
4*4*1-1/4"	133.00	114.76	114.10	60.00	42.42	42.04	34.00	106.00	38.00	157.50	214.00		
4*4*1-1/2"	133.00	114.76	114.10	60.00	48.56	48.11	37.00	106.00	43.00	160.50	214.00		
4*4*2"	133.00	114.76	114.10	60.00	60.63	60.17	41.00	106.00	54.00	164.50	214.00		
4*4*2-1/2"	133.00	114.76	114.10	60.00	73.38	72.85	46.50	106.00	67.00	171.00	214.00		
4*4*3"	133.00	114.76	114.10	60.00	89.31	88.70	50.00	106.00	82.00	174.50	214.00		
6*6*1"	191.00	168.83	168.00	79.00	33.65	33.27	30.00	158.00	30.00	220.00	311.00		
6*6*2"	191.00	168.83	168.00	79.00	60.63	60.17	39.00	158.00	54.00	220.50	311.00		
6*6*3"	191.00	168.83	168.00	79.00	89.31	88.71	50.00	158.00	82.00	230.50	311.00		
6*6*4"	191.00	168.83	168.00	79.00	114.76	114.10	60.00	158.00	106.00	243.00	311.00		
6*6*5"	191.00	168.83	168.00	79.00	141.81	141.00	68.00	158.00	133.00	250.50	311.00		

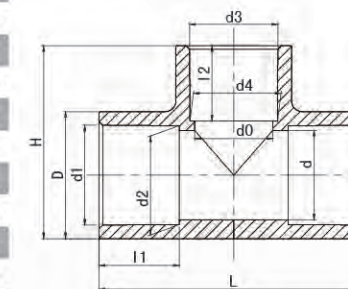

异径三通Reducing Tee(SxSxS)

DIN

Nominal Size	Outside Dia D	Socket Type						Structural Diameter			
		d1	d2	l1	d3	d4	l2	d	d0	H	L
DN20*DN20*DN15	33.00	25.30	25.10	20.00	20.30	20.10	17.00	23.00	17.00	49.00	66.00
DN25*DN25*DN15	41.00	32.30	32.10	23.00	20.30	20.10	17.00	29.00	17.00	56.00	80.00
DN25*DN25*DN20	41.00	32.30	32.10	23.00	25.30	25.10	20.00	29.00	23.00	59.00	80.00
DN32*DN32*DN15	50.00	40.30	40.10	28.00	20.30	20.10	17.00	37.00	17.00	64.50	96.00
DN32*DN32*DN20	50.00	40.30	40.10	28.00	25.30	25.10	20.00	37.00	23.00	67.50	96.00
DN32*DN32*DN25	50.00	40.30	40.10	28.00	32.30	32.10	23.00	37.00	29.00	68.50	96.00
DN40*DN40*DN15	62.00	50.30	50.10	32.00	20.30	20.10	17.00	47.00	17.00	75.50	118.00
DN40*DN40*DN20	62.00	50.30	50.10	32.00	25.30	25.10	20.00	47.00	23.00	78.50	118.00
DN40*DN40*DN25	62.00	50.30	50.10	32.00	32.30	32.10	23.00	47.00	29.00	79.50	118.00
DN40*DN40*DN32	62.00	50.30	50.10	32.00	40.30	40.10	28.00	47.00	37.00	84.50	118.00
DN50*DN50*DN15	76.00	63.30	63.10	38.00	20.30	20.10	17.00	60.00	17.00	89.00	143.00
DN50*DN50*DN20	76.00	63.30	63.10	38.00	25.30	25.10	20.00	60.00	23.00	92.00	143.00
DN50*DN50*DN25	76.00	63.30	63.10	38.00	32.30	32.10	23.00	60.00	29.00	93.00	143.00
DN50*DN50*DN32	76.00	63.30	63.10	38.00	40.30	40.10	28.00	60.00	37.00	98.00	143.00
DN50*DN50*DN40	76.00	63.30	63.10	38.00	50.30	50.10	32.00	60.00	47.00	102.00	143.00
DN65*DN65*DN25	92.00	75.30	75.10	45.00	32.30	32.10	23.00	72.00	29.00	109.00	171.00
DN65*DN65*DN32	92.00	75.30	75.10	45.00	40.30	40.10	28.00	72.00	37.00	114.00	171.00
DN65*DN65*DN40	92.00	75.30	75.10	45.00	50.30	50.10	32.00	72.00	47.00	118.00	171.00
DN65*DN65*DN50	92.00	75.30	75.10	45.00	63.30	63.10	38.00	72.00	60.00	124.00	171.00
DN80*DN80*DN25	110.60	90.30	90.10	51.00	32.30	32.10	23.00	87.10	29.00	125.80	182.00
DN80*DN80*DN32	110.60	90.30	90.10	51.00	40.30	40.10	28.00	87.10	37.00	130.80	182.00
DN80*DN80*DN40	110.60	90.30	90.10	51.00	50.30	50.10	32.00	87.10	47.00	134.80	182.00
DN80*DN80*DN50	110.60	90.30	90.10	51.00	63.30	63.10	38.00	87.10	60.00	140.80	182.00
DN80*DN80*DN65	110.60	90.30	90.10	51.00	75.30	75.10	45.00	87.10	72.00	147.80	182.00
DN100*DN100*DN25	127.00	110.40	110.10	61.00	32.30	32.10	23.00	106.10	29.00	144.50	219.00
DN100*DN100*DN32	127.00	110.40	110.10	61.00	40.30	40.10	28.00	106.10	37.00	149.50	219.00
DN100*DN100*DN40	127.00	110.40	110.10	61.00	50.30	50.10	32.00	106.10	47.00	153.50	219.00
DN100*DN100*DN50	127.00	110.40	110.10	61.00	63.30	63.10	38.00	106.10	60.00	159.50	219.00
DN100*DN100*DN65	127.00	110.40	110.10	61.00	75.30	75.10	45.00	106.10	72.00	166.50	219.00
DN100*DN100*DN80	127.00	110.40	110.10	61.00	90.30	90.10	51.00	106.10	87.10	172.50	219.00

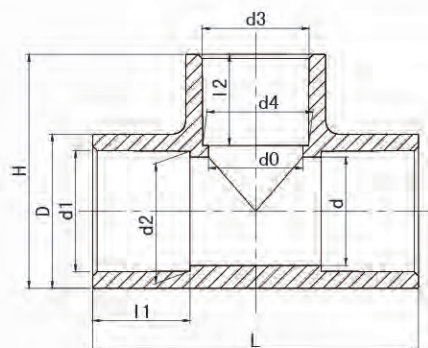

45°弯头Elbow(SxS)

ANSI NSF

Nominal Size	Outside Dia D	Socket Type			Structural Diameter	
		d1	d2	l	d	J
1/2"	30.00	21.54	21.23	24.00	16.00	6.50
3/4"	35.00	26.87	26.57	27.00	22.00	8.00
1"	44.00	33.65	33.27	30.00	30.00	8.00
1-1/4"	54.00	42.42	42.04	34.00	38.00	10.00
1-1/2"	60.00	48.56	48.11	37.00	43.00	12.00
2"	73.00	60.63	60.17	41.00	54.00	16.00
2-1/2"	88.00	73.38	72.85	46.50	67.00	18.00
3"	105.00	89.31	88.70	50.00	82.00	19.50
4"	132.00	114.76	114.10	60.00	106.00	26.00
5"	162.00	141.81	141.00	77.00	133.00	35.00
6"	191.00	168.83	168.00	79.00	158.00	45.00
8"	246.00	219.84	218.70	102.00	200.00	51.00
10" (手工件)	304.00	273.81	272.67	148.00	240.00	58.00
12" (手工件)	360.00	324.61	323.47	168.00	290.00	64.00

Note: Dimensions for handmade fittings shall per actual ones.
备注: 手工件请以实物为准

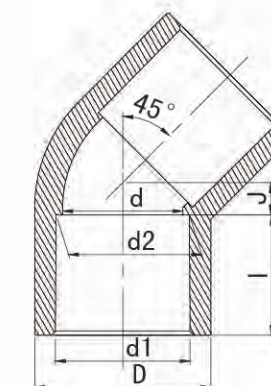

45°弯头Elbow(SxS)

DIN

Nominal Size	Socket Type			Structural Diameter	
	d1	d2	l	D	d
DN15	20.3	20.1	16.0	27.0	17.0
DN20	25.3	25.1	19.0	33.0	23.0
DN25	32.3	32.1	22.0	41.0	29.0
DN32	40.3	40.1	26.0	50.0	37.0
DN40	50.3	50.1	32.0	61.0	47.0
DN50	63.3	63.1	38.0	76.5	60.0
DN65	75.3	75.1	44.0	92.0	72.1
DN80	90.3	90.1	49.5	110.6	87.1
DN100	110.4	110.1	61.0	133.0	106.1
DN125	140.5	140.2	77.0	162.0	133.0
DN150	160.5	160.2	86.0	186.0	154.0
DN200	225.7	225.3	119.0	261.0	205.0
DN250 (手工件)	250.8	250.3	148.0	290.0	239.0
DN300 (手工件)	316.0	315.4	168.0	364.0	304.0

Note: Dimensions for handmade fittings shall per actual ones.
备注: 手工件请以实物为准

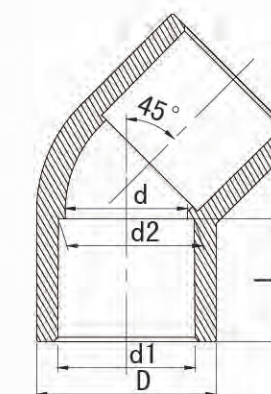

90°弯头Elbow(SxS)

ANSI

NSF

Nominal Size	Outside Dia D	Socket Type			Structural Diameter	
		d1	d2	l	d	L
1/2"	30.00	21.54	21.23	24.00	16.00	52.00
3/4"	35.00	26.87	26.57	27.00	22.00	59.50
1"	44.00	33.65	33.27	29.00	30.00	69.00
1-1/4"	54.00	42.42	42.04	34.00	38.00	84.00
1-1/2"	60.00	48.56	48.11	36.00	44.00	92.00
2"	73.00	60.63	60.17	39.00	54.00	107.50
2-1/2"	88.00	73.38	72.85	46.50	67.00	129.50
3"	105.00	89.31	88.70	50.00	82.00	149.50
4"	132.00	114.76	114.10	60.00	106.00	185.00
5"	162.00	141.81	141.00	77.00	133.00	234.50
6"	191.00	168.83	168.00	79.00	158.00	263.50
8"	246.00	219.84	218.70	102.00	200.00	340.00
10"	304.80	273.81	272.67	128.00	265.00	425.40
12" (手工件)	360.00	324.61	323.47	168.00	190.00	523.00

Note: Dimensions for handmade fittings shall per actual ones.
备注: 手工件请以实物为准

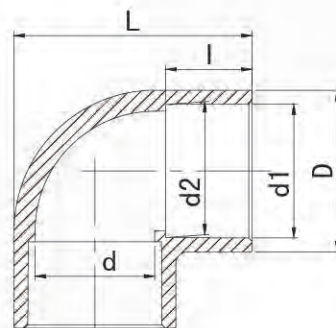

90°弯头Elbow(SxS)

DIN

Nominal Size	Socket Type			Structural Diameter		
	d1	d2	l	D	d	L
DN15	20.3	20.1	16.0	27.0	17.0	40.0
DN20	25.3	25.1	19.0	33.0	23.0	49.5
DN25	32.3	32.1	22.0	41.0	29.0	61.0
DN32	40.3	40.1	26.0	50.0	37.0	73.5
DN40	50.3	50.1	32.0	61.0	47.0	88.0
DN50	63.3	63.1	38.0	76.5	60.0	107.5
DN65	75.3	75.1	44.0	92.0	72.0	132.5
DN80	90.3	90.1	51.0	110.6	87.1	155.8
DN100	110.4	110.1	61.0	133.0	106.1	187.5
DN125	140.5	140.2	77.0	162.0	133.0	234.5
DN150	160.5	160.2	86.0	186.0	154.0	262.0
DN200	225.7	225.3	119.0	261.0	205.0	364.5
DN250(手工件)	250.8	250.3	148.0	290.0	239.0	696.0
DN300(手工件)	316.0	315.4	168.0	364.0	304.0	816.0

Note: Dimensions for handmade fittings shall per actual ones.
备注: 手工件请以实物为准

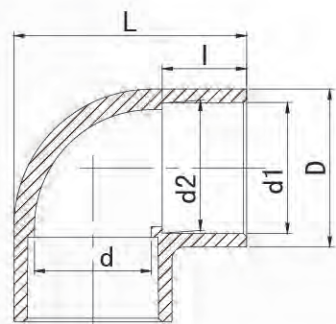

90°弯头Elbow(SxT)

ANSI

NSF

Nominal Size	Outside Dia D	Socket Type			Structural Diameter		
		d1	d2	l	d	L	NPT(牙数/寸)
1/2"	30.00	21.54	21.23	24.00	16.00	52.00	14.00
3/4"	35.00	26.87	26.57	27.00	22.00	59.50	14.00
1"	44.00	33.65	33.27	30.00	30.00	69.00	11.50
1-1/4"	54.00	42.42	42.04	34.00	38.00	84.00	11.50
1-1/2"	60.00	48.56	48.11	37.00	44.00	92.00	11.50
2"	73.00	60.63	60.17	41.00	54.00	107.50	11.50

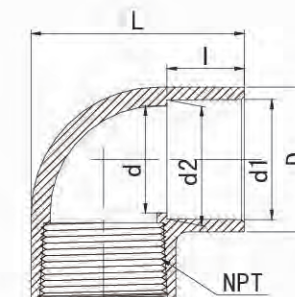

90°弯头Elbow(SxT)

DIN

Nominal Size	Outside Dia D	Socket Type			Structural Diameter		
		d1	d2	l	d	L	PT(牙数/寸)
DN15	27	20.3	20.1	16	17	40	14
DN20	33	25.3	25.1	19	23	49.5	14
DN25	41	32.3	32.1	22	29	61	11
DN32	50	40.3	40.1	26	37	73.5	11
DN40	61	50.3	50.1	32	47	88	11
DN50	76.5	63.3	63.1	38	60	107.5	11

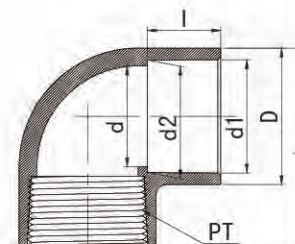

90°弯头Elbow(TxT)

ANSI

NSF

Nominal Size	Outside Dia D	Structural Diameter		
		d	L	NPT(牙数/寸)
1/2"	30.0	16.0	52.0	14.0
3/4"	35.0	22.0	59.5	14.0
1"	44.0	30.0	69.0	11.5
1-1/4"	54.0	38.0	84.0	11.5
1-1/2"	60.0	44.0	92.0	11.5
2"	73.0	54.0	107.5	11.5

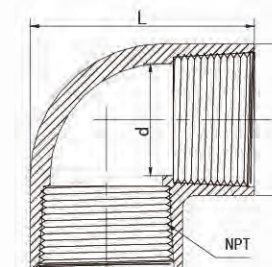

90°弯头Elbow(TxT)

DIN

Nominal Size	Outside Dia D	Structural Diameter		
		d	L	PT(牙数/寸)
DN15	27.0	17.0	40.0	14.0
DN20	33.0	23.0	49.5	14.0
DN25	41.0	29.0	61.0	11.0
DN32	50.0	37.0	73.5	11.0
DN40	61.0	47.0	88.0	11.0
DN50	76.5	60.0	107.5	11.0

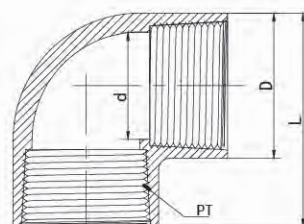

卜申Reducing Bushing (SxS)

DIN

Nominal Size	Outside Dia D	Socket Type			Structural Diameter			图示
		d1	d2	l	d	L1	L	
DN20*DN15	25.0	20.3	20.1	16.0	16.0	—	20.0	Pic.1
DN25*DN20	32.0	25.3	25.1	20.0	21.0	—	24.0	
DN32*DN25	40.0	32.3	32.1	23.0	28.0	—	28.0	
DN40*DN32	50.0	40.3	40.1	28.0	36.0	—	32.0	
DN50*DN40	63.0	50.3	50.1	32.0	46.0	—	38.0	
DN63*DN50	75.0	63.3	63.1	38.0	57.0	—	42.0	Pic.2
DN80*DN50	90.0	63.3	63.1	38.0	57.0	51.0	61.0	
DN80*DN65	90.0	75.3	75.1	45.0	71.0	51.0	61.0	
DN100*DN50	110.0	63.3	63.1	38.0	57.0	61.0	73.0	
DN100*DN80	110.0	90.3	90.1	51.0	86.0	61.0	73.0	
DN125*DN50	140.0	63.3	63.1	39.0	50.0	76.0	91.0	
DN125*DN80	140.0	90.3	90.1	51.0	80.0	76.0	91.0	
DN125*DN100	140.0	110.4	110.1	61.0	100.0	76.0	91.0	
DN150*DN80	160.0	90.3	90.1	51.0	80.0	86.0	101.0	
DN150*DN100	160.0	110.4	110.1	61.0	100.0	86.0	101.0	
DN150*DN125	160.0	140.5	140.2	76.0	125.0	86.0	101.0	
DN200*DN100	225.0	110.4	110.1	61.0	100.0	119.0	137.0	
DN200*DN125	225.0	140.5	140.2	76.0	125.0	119.0	137.0	
DN200*DN150	225.0	160.5	160.2	86.0	150.0	119.0	137.0	
DN250*DN100	280.0	110.4	110.1	61.0	100.0	146.0	166.0	
DN250*DN150	280.0	160.5	160.2	86.0	150.0	146.0	166.0	
DN250*DN200	280.0	225.7	225.3	119.0	200.0	146.0	166.0	

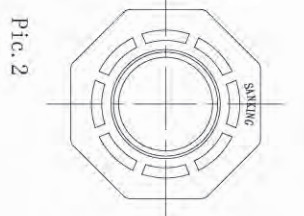
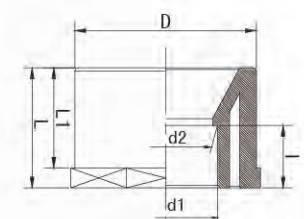
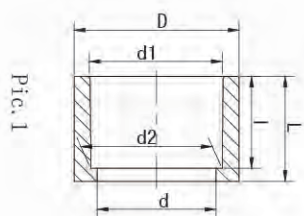

卜申Reducing Bushing (SxS)

ANSI

NSF

Nominal Size	Socket Type			Structural Diameter			
	d1	d2	l	D	d	L1	L
1/2**1/4"	14.02	13.61	19.00	21.34	10.00	24.00	29.00
1/2**3/8"	17.45	17.04	22.00	21.34	12.00	24.00	29.00
3/4**1/2"	21.54	21.23	24.00	26.67	17.00	27.00	33.00
1**3/8"	17.45	17.04	22.00	33.40	12.00	30.00	36.00
1**1/2"	21.54	21.23	24.00	33.40	17.00	30.00	36.00
1**3/4"	26.87	26.57	27.00	33.40	22.50	30.00	36.00
1-1/4**1/2"	21.54	21.23	24.00	42.16	17.00	34.00	42.00
1-1/4**3/4"	26.87	26.57	27.00	42.16	22.50	34.00	42.00
1-1/4**1"	33.65	33.27	30.00	42.16	28.00	34.00	42.00
1-1/2**1/2"	21.54	21.23	24.00	48.26	17.00	37.00	45.00
1-1/2**3/4"	26.87	26.57	27.00	48.26	22.50	37.00	45.00
1-1/2**1"	33.65	33.27	30.00	48.26	28.00	37.00	45.00
1-1/2**1-1/4"	42.42	42.04	34.00	48.26	38.00	37.00	45.00
2**1/2"	21.54	21.23	24.00	60.33	17.00	41.00	53.00
2**3/4"	26.87	26.57	27.00	60.33	22.50	41.00	53.00
2**1"	33.65	33.27	30.00	60.33	28.00	41.00	53.00
2**1-1/4"	42.42	42.04	34.00	60.33	38.00	41.00	53.00
2**1-1/2"	48.56	48.11	37.00	60.33	42.00	41.00	53.00
2-1/2**1-1/2"	48.56	48.11	37.00	73.03	44.00	46.50	56.50
2-1/2**2"	60.63	60.17	41.00	73.03	54.00	46.50	56.50
3**1"	33.65	33.27	30.00	88.90	28.00	50.00	60.00
3**1-1/2"	48.56	48.11	37.00	88.90	42.00	50.00	60.00
3**2"	60.63	60.17	41.00	88.90	54.00	50.00	60.00
3**2-1/2"	73.38	72.85	46.50	88.90	66.00	50.00	60.00
4**2"	60.63	60.17	41.00	114.30	54.00	60.00	72.00
4**2-1/2"	73.38	72.85	46.50	114.30	65.00	60.00	72.00
4**3"	89.31	88.70	50.00	114.30	80.00	60.00	72.00
5**2"	60.63	60.17	39.00	141.30	55.00	66.80	81.80
5**3"	89.31	88.70	51.00	141.30	80.00	66.80	81.80
5**4"	114.76	114.10	61.00	141.30	100.00	66.80	81.80
6**3"	89.31	88.70	51.00	168.28	80.00	79.00	94.00
6**4"	114.76	114.10	61.00	168.28	100.00	79.00	94.00
6**5"	141.81	141.00	76.00	168.28	125.00	79.00	94.00
8**4"	114.76	114.10	61.00	219.10	100.00	102.00	120.00
8**5"	141.81	141.00	76.00	219.10	125.00	102.00	120.00
8**6"	168.83	168.00	86.00	219.10	150.00	102.00	120.00
10**4"	114.76	114.10	61.00	273.50	100.00	128.00	148.00
10**6"	168.83	168.00	86.00	273.50	150.00	128.00	148.00
10**8"	219.84	218.69	119.00	273.50	200.00	128.00	148.00

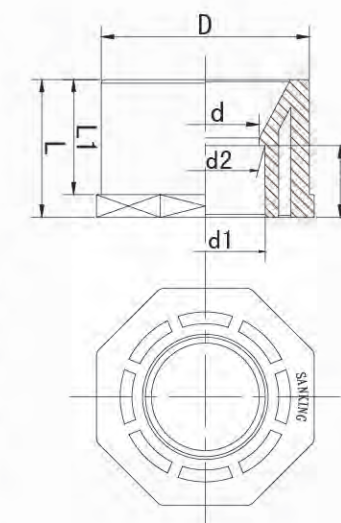

└申 Reducing Bushing (SxT)

ANSI

NSF

Nominal Size	Outside Dia D	Structural Diameter d	Structural Diameter			NPT(牙数/寸)
			L1	L	L	
1/2**1/4"	21.34	7.00	24.00	29.00	18.00	
1/2**3/8"	21.34	12.00	24.00	29.00	18.00	
3/4**1/2"	26.67	16.00	27.00	33.00	14.00	
1**3/8"	33.40	12.00	30.00	36.00	18.00	
1**1/2"	33.40	16.00	30.00	36.00	14.00	
1**3/4"	33.40	21.00	30.00	36.00	14.00	

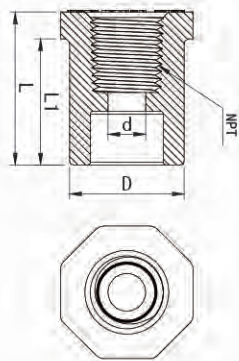

└申 Reducing Bushing (SxT)

DIN

Nominal Size	Outside Dia D	Structural Diameter d	Structural Diameter			PT(牙数/寸)	图示
			L1	L	L		
DN20*DN15	25	16	—	20	14	Pic.1	
DN25*DN20	32	21	—	24	14		
DN32*DN25	40	28	—	28	11		
DN40*DN32	50	36	—	32	11		
DN50*DN40	63	46	—	38	11		
DN63*DN50	75	57	—	42	11	Pic.2	
DN80*DN50	90	57	51	61	11		
DN80*DN65	90	71	51	61	11		
DN100*DN50	110	57	61	73	11		
DN100*DN80	110	86	61	73	11		

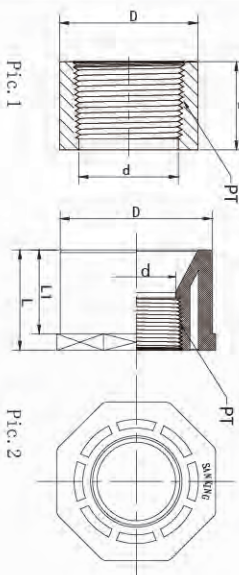

管帽 Cap

ANSI

Nominal Size	Outside Dia D	Socket Type			Structural Diameter L
		d1	d2	l	
1/2"	30.00	21.54	21.23	24.00	28.50
3/4"	35.00	26.87	26.57	27.00	31.50
1"	43.50	33.65	33.27	30.00	35.00
1-1/4"	53.00	42.42	42.04	33.00	38.50
1-1/2"	60.00	48.56	48.11	37.00	43.00
2"	73.00	60.63	60.17	40.00	46.00
2-1/2"	92.00	73.38	72.85	47.00	55.50
3"	110.60	89.31	88.70	52.50	62.50
4"	133.00	114.76	114.10	63.00	72.00

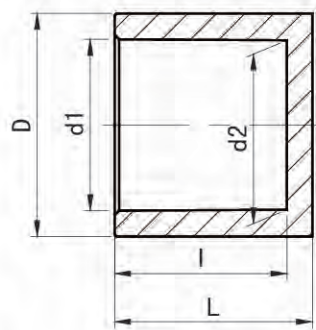

管帽 Cap

DIN

Nominal Size	Outside Dia D	Socket Type			Structural Diameter L
		d1	d2	l	
DN15	27.0	20.3	20.1	19.9	24.0
DN20	32.0	25.3	25.1	24.3	28.3
DN25	40.0	32.3	32.1	28.0	32.0
DN32	50.0	40.3	40.1	32.0	37.0
DN40	63.0	50.3	50.1	35.7	41.3
DN50	75.0	63.3	63.1	42.0	48.0
DN65	92.0	75.3	75.1	47.0	55.5
DN80	110.6	90.3	90.1	52.5	62.5
DN100	133.0	110.4	110.1	63.0	72.0

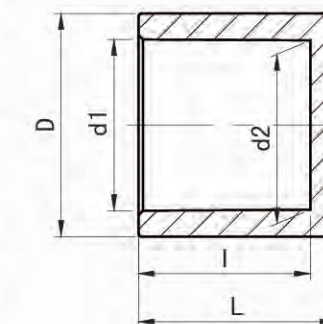

双片式法兰 Van Stone Flange

ANSI

Size	D	D1	C	d	d1	d2	H	T	l	n-Φe
1/2"	87.00	30.00	60.30	15.00	21.54	21.23	26.00	14.00	23.00	4-16
3/4"	98.00	38.00	70.00	20.00	26.87	26.57	29.00	15.00	26.00	4-16
1"	108.00	47.00	79.40	25.00	33.66	33.27	33.00	16.00	29.00	4-16
1-1/4"	117.00	55.00	88.90	32.00	42.42	42.04	37.00	18.00	32.00	4-16
1-1/2"	128.00	60.50	98.00	40.00	48.56	48.11	42.80	19.00	36.60	4-16
2"	155.50	73.80	121.00	51.00	60.63	60.17	45.50	21.00	40.00	4-19
2-1/2"	178.00	89.00	140.00	63.00	73.38	72.85	52.50	25.00	46.50	4-19
3"	192.00	108.00	152.00	77.00	89.31	88.70	56.50	27.00	50.00	4-19
4"	230.00	133.00	191.20	102.00	114.76	114.10	67.00	29.00	59.80	8-19
5"	256.00	161.80	216.00	129.00	141.81	141.00	77.50	31.00	69.40	8-22
6"	285.00	191.00	241.00	156.00	168.83	168.00	88.00	33.00	79.00	8-22
8"	343.00	243.00	298.00	204.00	219.84	218.70	118.00	36.00	102.00	8-22
10"	406.40	308.00	362.00	256.00	273.81	272.67	151.00	42.00	127.50	12-25
12"	483.00	364.00	432.00	305.00	324.61	323.47	190.00	42.00	165.00	12-25

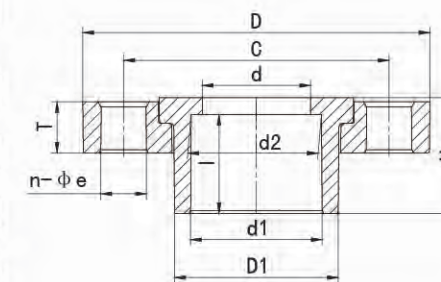

双片式法兰 Van Stone Flange

DIN

Size	D	D1	C	d	d1	d2	H	T	l	n-Φe
8"	343.0	248.0	298.0	204.0	225.7	225.3	131.0	36.0	119.0	8-23
10"	395.0	275.0	350.0	225.0	250.8	250.3	141.0	32.0	131.5	12-23
12"	445.0	346.0	400.0	300.0	316.0	315.4	190.0	42.0	165.0	12-23

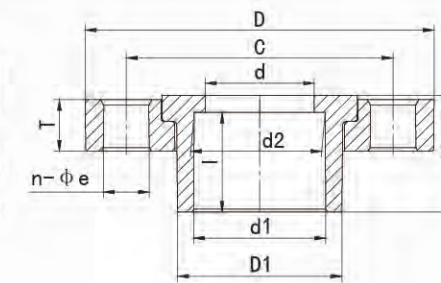

盲法兰 Blind Flange

ANSI unit:mm

Size	D	D1	C	H	T	n-Φe
6"	280.0	215.9	214.3	1.6	25.4	8-23.0
8"	343.0	269.7	298.5	1.6	28.4	8-23.5

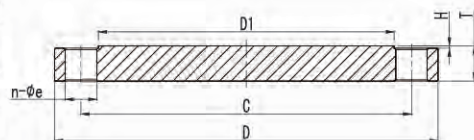

单片式法兰及表格 T/S Flange

DIN

Size	D	D1	C		d	d1		d2		H	T	l	n-Φe	
			DIN	JIS		DIN	JIS	DIN	JIS				DIN	JIS
1/2"	95	32	65	70	15	20.30	22.40	20.10	21.73	35	14	32	4-15	4-15
3/4"	105	35	75	75	20	25.30	26.45	25.10	25.69	40	15	37	4-15	4-15
1"	125	42	85	90	25	32.30	32.55	32.10	31.70	45	16	40	4-19	4-19
1-1/4"	140	52	100	100	32	40.30	38.60	40.10	37.65	49	16	44	4-19	4-19
1-1/2"	150	62	110	105	43	50.30	48.70	50.10	47.74	59	18	54	4-19	4-19
2"	165	76	125	120	55	63.30	60.80	63.10	59.78	66	20	61	4-19	4-19
2-1/2"	185	90	145	140	65	75.30	76.60	75.10	75.68	70	22	61	4-19	4-19
3"	200	108	160	150	80	90.30	89.60	90.10	88.55	73	22	65	8-19	8-19
4"	220	132	180	175	100	110.40	114.70	110.10	113.60	93	22	84	8-19	8-19
5"	250	162	210	210	125	140.50	140.85	140.20	139.64	114	24	103	8-19	8-23
6"	285	187	240	240	150	160.50	166.00	160.20	164.63	142	26	130	8-23	8-23
10"	395	309	350	—	250	280.90	—	280.30	—	156	28	147	12-23	—

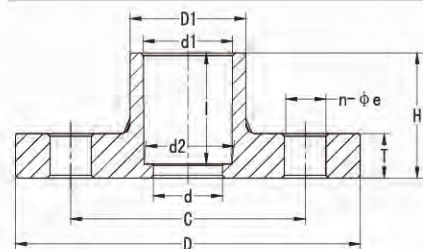

unit:mm

Size	C (中心圆)					n-Φe (孔数、螺孔数)					螺丝规格-螺丝数					d
	JIS	CNS	DIN	ANSI	BS	JIS	CNS	DIN	ANSI	BS	JIS	CNS	DIN	ANSI	BS	
1/2"	70.00	70.00	65.00	60.30	66.70	15-4	15-4	14-4	16-4	16-4	M12-4	M12-4	M12-4	W1/2-4	W1/2-4	15
3/4"	75.00	75.00	75.00	70.00	73.00	15-4	15-4	14-4	16-4	16-4	M12-4	M12-4	M12-4	W1/2-4	W1/2-4	20
1"	90.00	90.00	85.00	79.40	82.60	19-4	19-4	14-4	16-4	16-4	M16-4	M16-4	M12-4	W1/2-4	W1/2-4	25
1-1/4"	100.00	100.00	100.00	88.90	87.30	19-4	19-4	18-4	16-4	16-4	M16-4	M16-4	M16-4	W1/2-4	W1/2-4	32
1-1/2"	105.00	105.00	110.00	98.40	98.40	19-4	19-4	18-4	16-4	16-4	M16-4	M16-4	M16-4	W1/2-4	W1/2-4	40
2"	120.00	120.00	125.00	120.70	114.30	19-4	19-4	18-4	19-4	19-4	M16-4	M16-4	M16-4	W5/8-4	W5/8-4	50
2-1/2"	140.00	140.00	145.00	139.50	127.00	19-4	19-4	18-4	19-4	19-4	M16-4	M16-4	M16-4	W5/8-4	W5/8-4	65
3"	150.00	150.00	160.00	152.40	146.10	19-8	19-8	18-8	19-4	19-4	M16-8	M16-8	M16-8	W5/8-4	W5/8-4	80
4"	175.00	175.00	180.00	190.50	177.80	19-8	19-8	18-8	19-8	19-8	M16-8	M16-8	M16-8	W5/8-8	W5/8-8	100
5"	210.00	210.00	210.00	215.90	209.60	23-8	23-8	18-8	22-8	19-8	M20-8	M20-8	M20-8	W3/4-8	W5/8-8	125
6"	240.00	240.00	240.00	241.50	235.00	23-8	23-8	23-8	22-8	22-8	M20-8	M20-8	M20-8	W3/4-8	W3/4-8	150
8"	290.00	290.00	295.00	298.50	292.10	23-12	23-12	23-8	22-8	22-8	M20-12	M20-12	M20-12	W3/4-8	W3/4-8	200
10"	355.00	355.00	350.00	362.00	355.60	25-12	25-12	23-12	25-12	25-12	M22-12	M22-12	M22-12	W7/8-12	W3/4-12	250
12"	400.00	400.00	400.00	431.80	406.40	25-16	25-16	23-12	25-12	25-12	M22-16	M22-16	M22-16	W7/8-12	W7/8-12	300

活接由令 Union

尺寸规格 (Dimension) unit:mm

Size	d	d1				d2				D	L		L1		
		ANSI	DIN	JIS	CNS	ANSI	DIN	JIS	CNS		ANSI	JIS	ANSI	JIS	DIN
1/2"(15)	15	21.54	20.30	22.40	22.40	21.23	20.10	21.73	21.90	54.00	53.50	41.00	22.30	16.00	
3/4"(20)	20	26.87	25.30	26.45	26.40	26.57	25.10	25.69	25.90	63.00	60.00	47.50	25.50	19.00	
1"(25)	25	33.65	32.30	32.55	34.50	33.27	32.10	31.70	33.90	73.50	67.00	53.50	28.60	22.00	
1-1/4"(32)	32	42.42	40.30	38.60	42.50	42.04	40.10	37.65	41.90	84.50	76.00	63.00	32.00	26.00	
1-1/2"(40)	40	48.56	50.30	48.70	48.60	48.11	50.10	47.74	47.90	98.00	83.00	78.00	35.00	32.00	
2"(50)	50	60.63	63.30	60.80	60.60	60.17	63.10	59.78	59.90	119.00	90.00	83.00	38.00	38.00	
2-1/2"(65)	63	73.38	75.30	76.60	76.70	72.85	75.10	75.68	75.90	150.00	110.00	100.00	47.00	47.00	
3"(80)	75	89.31	90.40	89.60	89.70	88.70	90.10	88.55	88.90	169.00	127.00	120.00	51.00	51.00	
4"(100)	97	114.76	110.40	114.70	115.00	114.10	110.10	113.60	113.80	211.00	158.00	150.00	61.00	61.00	

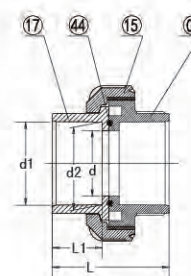

44	O圈	EPDM/VITON	1
17	管接头	UPVC/CPVC/PP/PVDF	1
15	螺帽	UPVC/CPVC/PP/PVDF	1
01	活接本体	UPVC/CPVC/PP/PVDF	1
序号	名称	材料	数量 (PCS)

软管外牙接头 (Hose Adapter)

unit:mm

Size	Nominal			Structural Diameter									
	DN1	DN2	DN3	d	D1	D2	T	L1	L	W	PT(n/in)	NPT(n/in)	
1/4"	8	10	12	6	8	14	4	12.7	43.7	18	19	18	
1/2"	8	10	12	14	8	14	6	16.4	49.5	27.5	14	14	

双外牙接头 (Nipple)

unit:mm

Nominal	Structural Diameter							
	Size	d	D	T	L1	L	W	PT(n/in)
1/4"	6	11	4	12.7	29.4	18	19	18
1/2"	14	18.5	6	16.5	39	27.5	14	14
3/4"	18	23.8	6	17.5	41	33	14	14
1"	23	29.6	8	22	52	39.5	11	11.5

鞍形取样接头 Sampling Header(S)

DIN

Nominal Size(dn)	Outside Dia			Socket Type			Structural Diameter	
	D	D1	D2	d1	d2	l	d	L
32x20x16	32	20	16	16.3	16.1	14.5	10.0	36.37
32x25x20	32	25	20	20.3	20.1	16.5	14.0	38.5
40x20x16	40	20	16	16.3	16.1	14.5	10.0	34.2
40x25x20	40	25	20	20.3	20.1	16.5	14.0	39.78
40x32x25	40	32	25	25.3	25.1	19.0	18.0	42.63
50x20x16	50	20	16	16.3	16.1	14.5	10.0	32.92
50x25x20	50	25	20	20.3	20.1	16.5	14.0	37.3
50x32x25	50	32	25	25.3	25.1	19.0	18.0	46.23
50x40x32	50	40	32	32.3	32.1	22.5	24.0	50.08
63x20x16	63	20	16	16.3	16.1	14.5	10.0	32
63x25x20	63	25	20	20.3	20.1	16.5	14.0	35.75
63x32x25	63	32	25	25.3	25.1	19.0	18.0	42.81
63x40x32	63	40	32	32.3	32.1	22.5	24.0	52.36
63x50x40	63	50	40	40.3	40.1	26.5	31.5	56.88
75x20x16	75	20	16	16.3	16.1	14.5	10.0	31.48
75x25x20	75	25	20	20.3	20.1	16.5	14.0	34.91
75x32x25	75	32	25	25.3	25.1	19.0	18.0	41.22
75x40x32	75	40	32	32.3	32.1	22.5	24.0	49.12
75x50x40	75	50	40	40.3	40.1	26.5	31.5	62.46
75x63x50	75	63	50	50.3	50.1	31.5	38.0	69.76
90x20x16	90	20	16	16.3	16.1	14.5	10.0	31.03
90x25x20	90	25	20	20.3	20.1	16.5	14.0	34.22
90x32x25	90	32	25	25.3	25.1	19.0	18.0	40
90x40x32	90	40	32	32.3	32.1	22.5	24.0	46.91
90x50x40	90	50	40	40.3	40.1	26.5	31.5	57.54
90x63x50	90	63	50	50.3	50.1	31.5	38.0	72.67
90x75x63	90	75	63	63.3	63.1	38.0	48.0	90.3
110x20x16	110	20	16	16.3	16.1	14.5	10.0	30.64
110x25x20	110	25	20	20.3	20.1	16.5	14.0	33.62
110x32x25	110	32	25	25.3	25.1	19.0	18.0	38.96
110x40x32	110	40	32	32.3	32.1	22.5	24.0	45.17
110x50x40	110	50	40	40.3	40.1	26.5	31.5	54.3
110x63x50	110	63	50	50.3	50.1	31.5	38.0	66.69
110x75x63	110	75	63	63.3	63.1	38.0	48.0	80.18

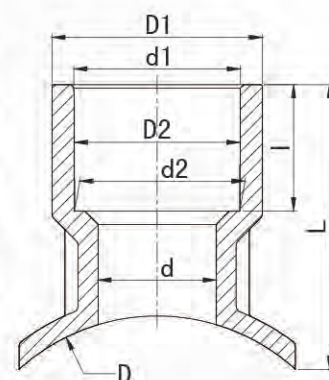

鞍形取样接头 Sampling Header(T)

DIN

Nominal Size	Outside Dia		Structural Diameter			
	D	D1	d	L	Threaded(n/in)	
					NPT	BSPF/PT
dn32x1/4"	32	20	10	36.37	18	19
dn32x3/8"	32	20	10	36.37	18	19
dn32x1/2"	32	25	14	38.5	14	14
dn40x1/4"	40	20	10	34.2	18	19
dn40x3/8"	40	20	10	34.2	18	19
dn40x1/2"	40	25	14	39.78	14	14
dn40x3/4"	40	32	18	42.63	14	14
dn50x1/4"	50	20	10	32.92	18	19
dn50x3/8"	50	20	10	32.92	18	19
dn50x1/2"	50	25	14	37.3	14	14
dn50x3/4"	50	32	18	46.23	14	14
dn50x1"	50	40	24	50.08	11.5	11
dn63x1/4"	63	20	10	32	18	19
dn63x3/8"	63	20	10	32	18	19
dn63x1/2"	63	25	14	35.75	14	14
dn63x3/4"	63	32	18	42.81	14	14
dn63x1"	63	40	24	52.36	11.5	11
dn75x1/4"	75	20	10	31.48	18	19
dn75x3/8"	75	20	10	31.48	18	19
dn75x1/2"	75	25	14	34.91	14	14
dn75x3/4"	75	32	18	41.22	14	14
dn75x1"	75	40	24	49.12	11.5	11
dn90x1/4"	90	20	10	31.03	18	19
dn90x3/8"	90	20	10	31.03	18	19
dn90x1/2"	90	25	14	34.22	14	14
dn90x3/4"	90	32	18	40	14	14
dn90x1"	90	40	24	46.91	11.5	11
dn110x1/4"	110	20	10	30.64	18	19
dn110x3/8"	110	20	10	30.64	18	19
dn110x1/2"	110	25	14	33.62	14	14
dn110x3/4"	110	32	18	38.96	14	14
dn110x1"	110	40	24	45.17	11.5	11

